

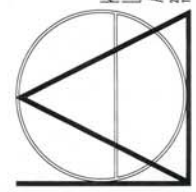

BOLESKINE & WHITTIER WAREHOUSE DEVELOPMENT
STORMPOINT HOLDINGS LTD., VICTORIA, B.C.

KEITH N. GRANT
LANDSCAPE ARCHITECTURE LTD.
2574 HANCOCK ROAD, VICTORIA, B.C. CANADA V8P 3T3
TEL: (250) 386-7877



NO.	DATE	DESCRIPTION
1	27/10/08	ING ROOF ACCESS, GREEN ROOF, ROOF PLANTER
2	26/09/09	ING ROOF PLANTER, PLANTER, PLANTER, PLANTER
3	16/06/09	ING ROOF PLANTER, PLANTER, PLANTER, PLANTER

SCALE: 1:200
PLOT: 1 = .2

DATE: JUN 16, 2009
FILE: 376 08 01

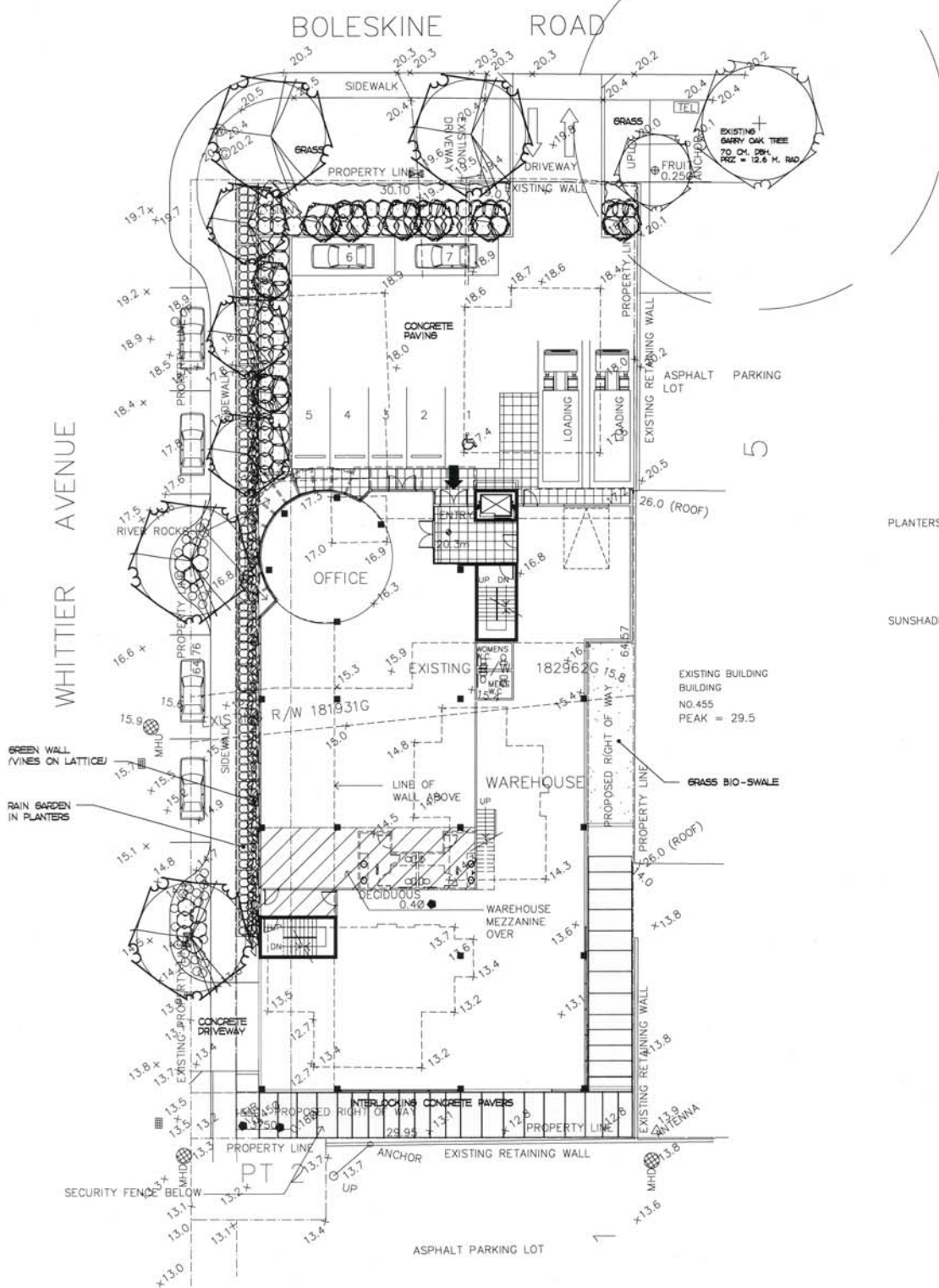

① SITE PLAN

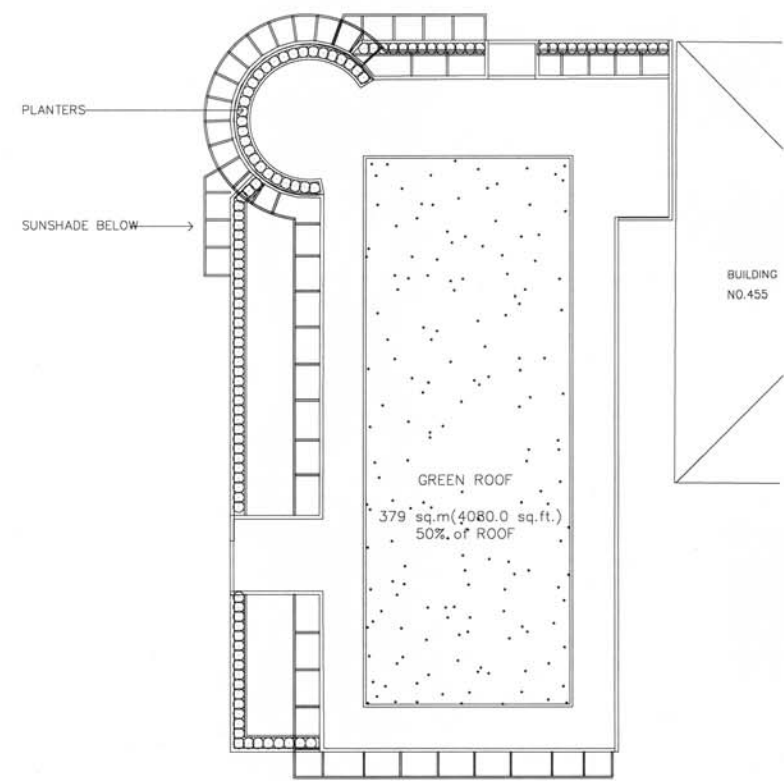

② ROOF PLAN

- LEGEND**
- LARGE DECIDUOUS TREES:
BIGLEAF MAPLE (ACER MACROPHYLLUM)
SIZE 7.0 CM. CAL., QUANTITY - 4
NOTE: TREES ON SAANICH PROPERTY TO SAANICH STANDARDS.
 - COLUMNAR FORM DECIDUOUS TREES:
BONHALL RED MAPLE
SIZE 5.0 CM. CAL., QUANTITY - 3
 - SMALL DECIDUOUS TREES:
VINE MAPLE, MAGNOLIA
SIZE 2.5 M. HT., QUANTITY - 8
 - MEDIUM SHRUBS:
NOOTKA ROSE (DEC), EV. HUCKLEBERRY (BU),
SNOWBERRY (DEC), OREGON GRAPE (BU),
SIZE #3 POTS, QUANTITY - 88
 - SMALL SHRUBS:
DWARF MAHONIA (BU), SHARD FERN (BU),
WILLOW LEAF COTONEASTER (PLANTERS) (BU),
DWARF REDTWIN DOGWOOD
SIZE #1 POT, QUANTITY - 326
 - GROUND COVER:
KINKIFANCK (BU), WINTERSGREEN (BU),
BOSTON IVY
SIZE 10 CM. POT, 45 CM. O.C.
 - VINES ON GREEN WALL WIRE SUSPENSION SYSTEM:
BOSTON IVY
SIZE #1 POTS, QUANTITY - 20
 - EXISTING DECIDUOUS TREES TO BE RETAINED
 - EXISTING TREES TO BE REMOVED

- NOTES**
- SEE ARCHITECTURAL AND CIVIL DRAWINGS FOR SITE GRADING.
 - NEW PLANTING AREAS TO BE IRRIGATED WITH A WATER EFFICIENT DRIP IRRIGATION SYSTEM.
 - PLANTING TO BE INSTALLED TO B.C. LANDSCAPE STANDARD - 7TH EDITION.
 - STORMWATER MANAGEMENT REPORT
 - REFER TO STORMWATER MANAGEMENT REPORT PREPARED BY WESTBROOK CONSULTING LTD.

